

DC Wallbox 25kW

Firmware v02.05.xx.11

Package updating instruction

26/01/2023



DC Wallbox 25kW

Firmware v02.05.xx.11

Package updating instruction



26/01/2023



Preparation for firmware (FW) update

- ❑ 3 x empty USB sticks are required, please label them, for example, as follows:
 - 1st USB: “Backup ” to preserve the old log file.
 - 2nd USB: “FW update” to upload firmware.
 - 3rd USB: “New log” to download new log file.
- ❑ USB stick mandatory requirements:
 - Formatted as file system to FAT/FAT32.
 - The capacity of the USB stick must be less than 32GB.

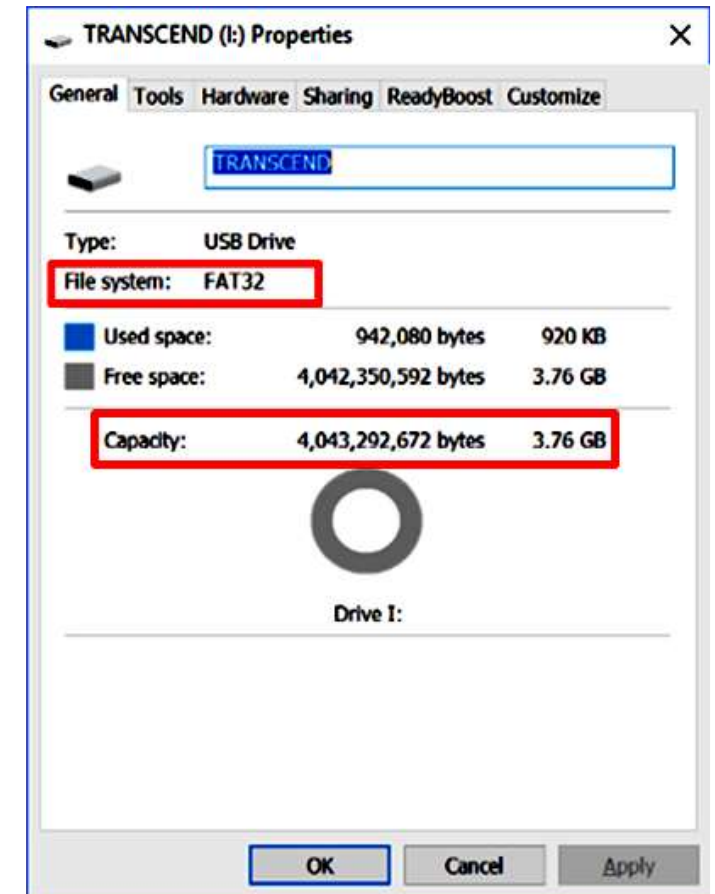

Single model firmware download link

- Applicable model: EVDE25E4DUM, Single CCS2 connector only
- Filename: Single_v02.05_DCWB25kW.7z
- Download link:



<https://reurl.cc/Kp18dM>

Attention! DO NOT change the filename!

Download password: BV3d26g7laAd

- After downloading, unzip the 7z file to get two firmware files:
 - 5505604249F
 - DCWB25kW.zip

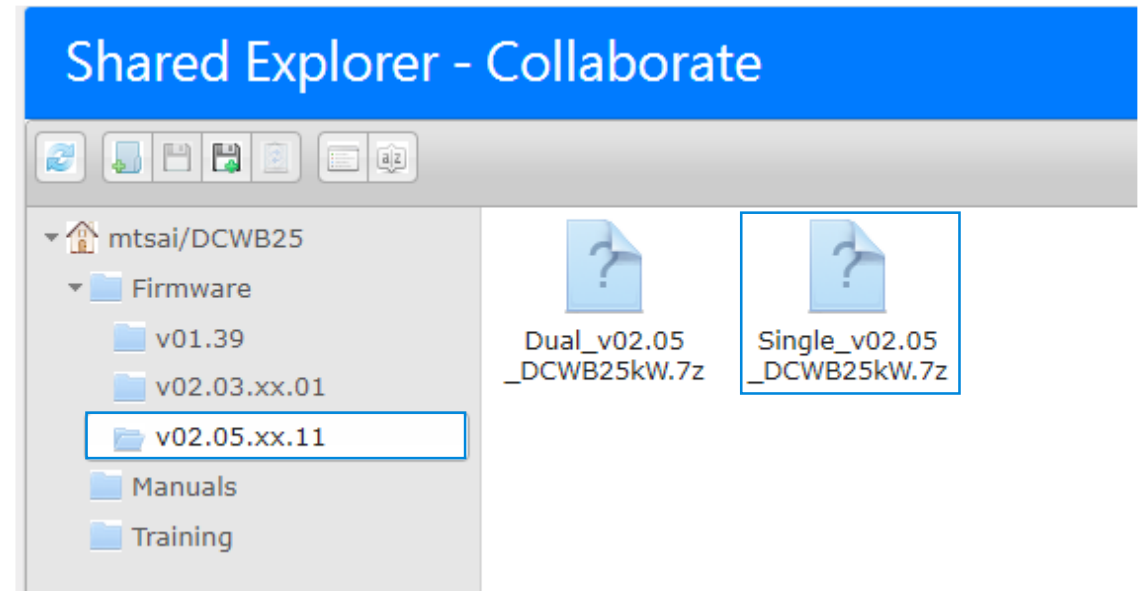

Dual model firmware download link

- Applicable model: EVDE25D4DUM, CCS2 with CHAdeMO connectors
- Filename: Dual_v02.05_DCWB25kW.7z
- Download link:



<https://reurl.cc/Kp18dM>

Attention! DO NOT change the filename!

Download password: BV3d26g7laAd

- After downloading, unzip the 7z file to get two firmware files:
 - 5505604249F
 - DCWB25kW.zip

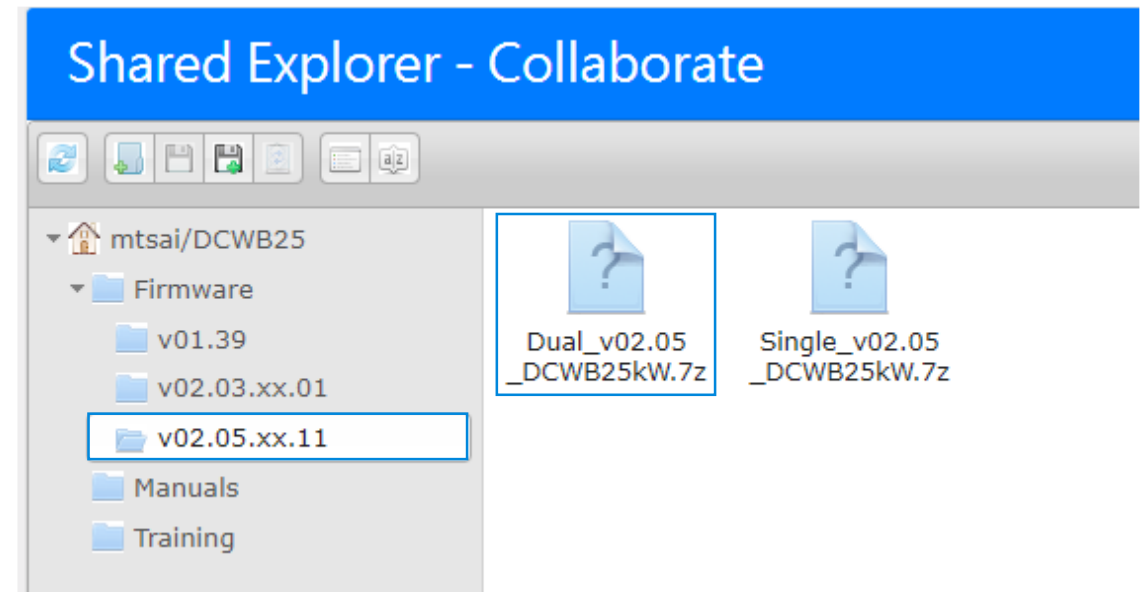

Firmware update procedure

1. Pre-procedure:

- 1.1. Insert the 1st USB stick to download the log file for backup.
- 1.2. Use the key to switch the power off. Wait at least 20 seconds for the system to discharge completely, to ensure the internal memory is clean, and then power on again.
- 1.3. Wait for the system to return to standby mode (display shows: “Tap card or use app”)

2. Upload the first firmware file (5505604249F)

- 2.1. Copy the file (5505604249F) to the root directory of the 2nd USB stick.
- 2.2. Insert the 2nd USB stick into the USB port at the bottom of the charger. The update will start automatically and take approximately 50 minutes.
- 2.3. When the screen shows: “Remove USB” unplug the USB stick. The system should perform an auto-restart. Wait until the system returns to standby mode.
- 2.4. Delete file 5505604249F from the 2nd USB stick.

3. Upload the second firmware file (DCWB25kW.zip) by copying it to the root directory of the 2nd USB stick, and repeat the upload procedure, this should take about 10 minutes.

4. Validate the result:

- 4.1. Insert the 3rd USB stick to download the log file.
- 4.2. Validate the result regarding the firmware version and configuration.

Download the existing log file

Pre-procedure:

- Open USB port at the bottom.
- Insert 1st USB stick to download old log file for backup.
- When display shows “Remove USB” unplug the USB stick
- The system will return to standby mode after USB removal

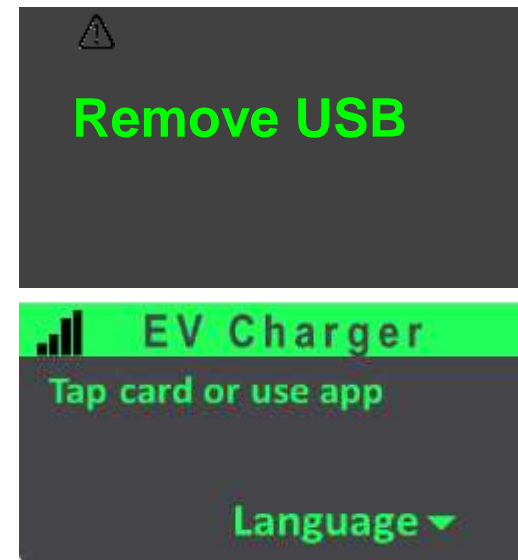

Perform a power cycle

Pre-procedure:

- Switch the key located on the left-hand side to the “OFF” position.
- **Wait 20 seconds (Mandatory!: To completely discharge system).**
- Switch the key position to “ON”, wait 3 minutes until “Tap card or use app” is displayed.



Keys

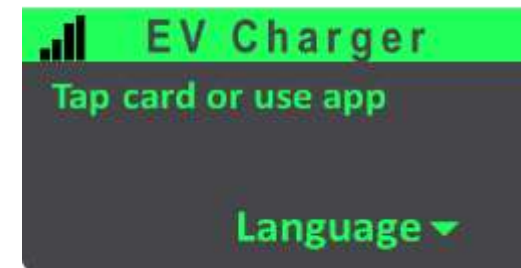
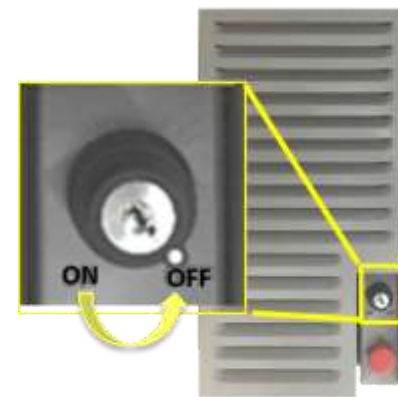

Standby mode

Upload first firmware

- Insert the 2nd USB stick into the port, the procedure will start automatically.
- First firmware (5505604249F) and second firmware (DCWB25kW.zip) must be uploaded separately.



USB port at the bottom

Step 2: Display messages during firmware upload

Uploading first firmware (5505604249F):

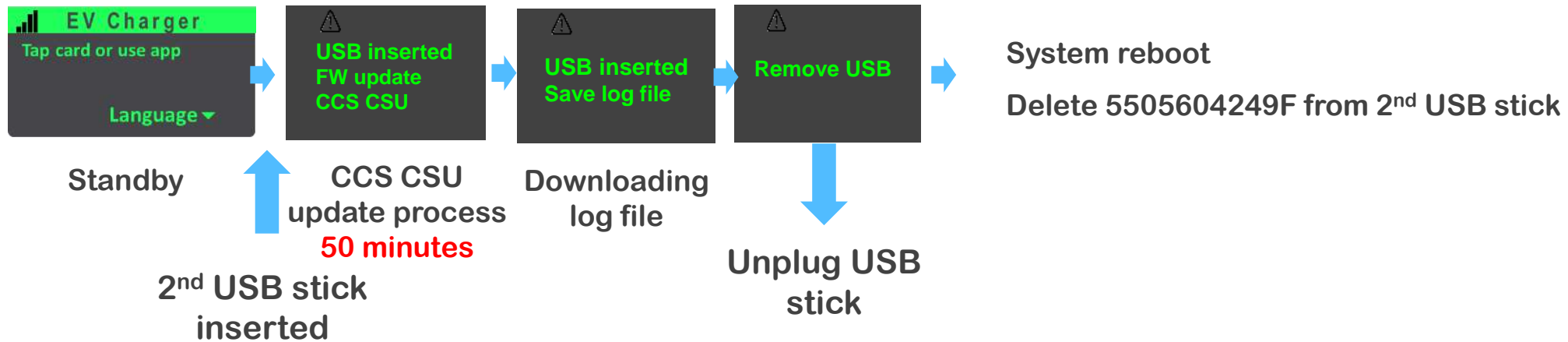

Uploading second firmware (DCWB25kW.zip):

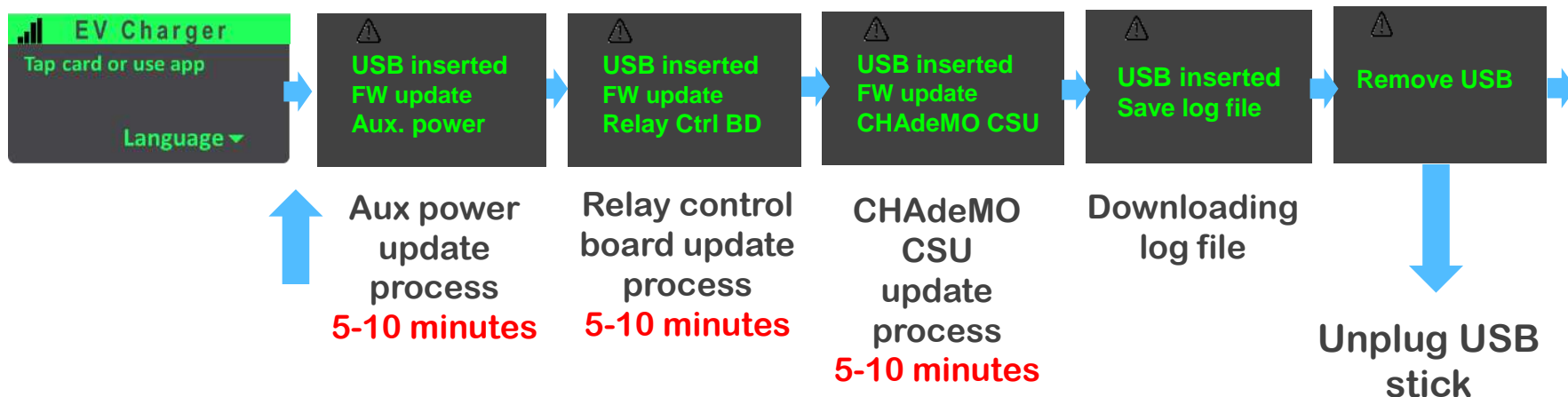

Step 2: Display messages during firmware upload

Uploading first firmware (5505604249F):

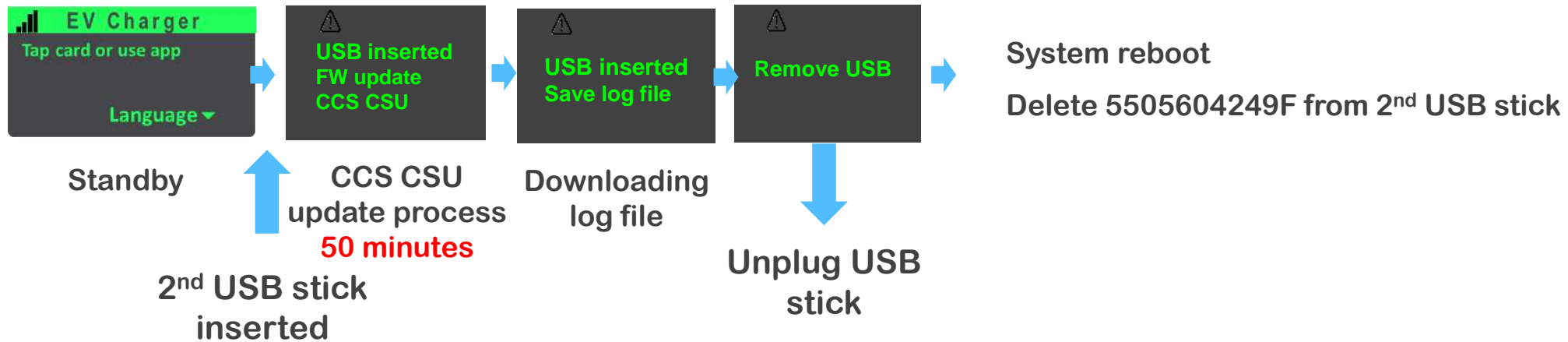

Uploading second firmware (DCWB25kW.zip):

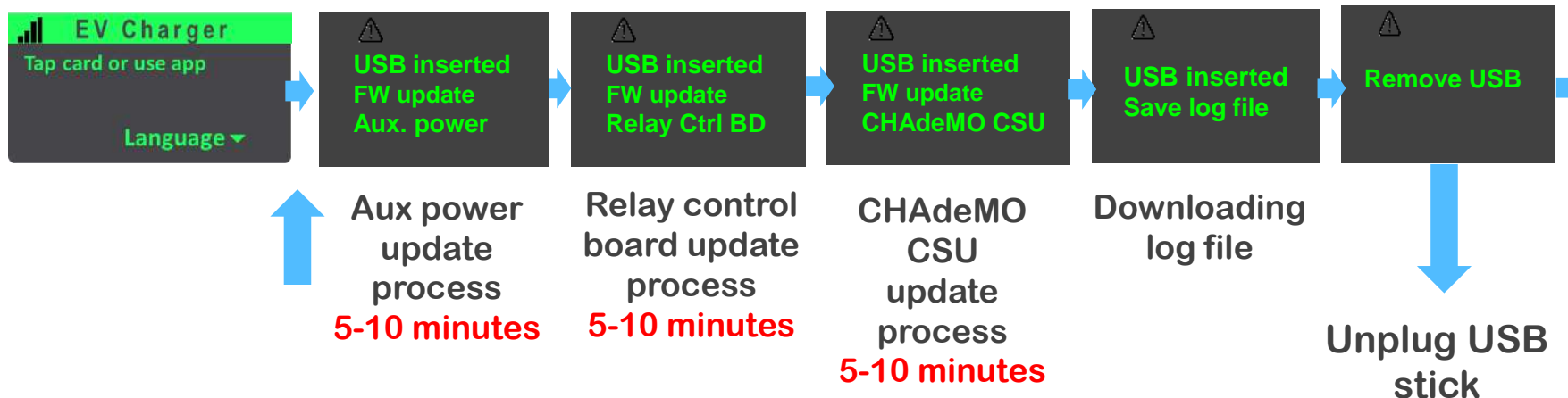

Screen messages during auto-restart

- When the display shows “Remove USB”.
Unplug the USB stick.
- The system will perform an auto-restart.
- Wait a few minutes until the system returns to standby mode.

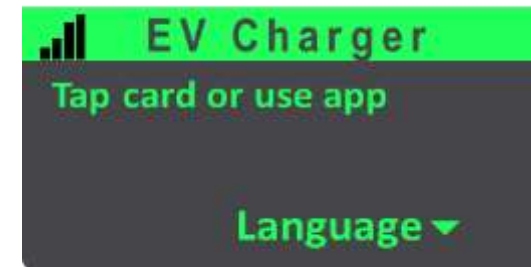
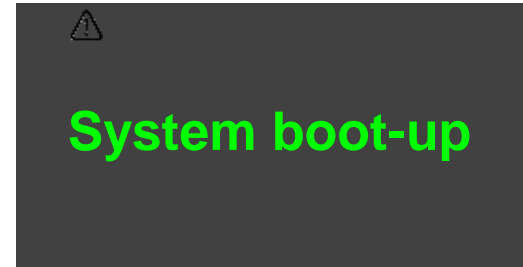
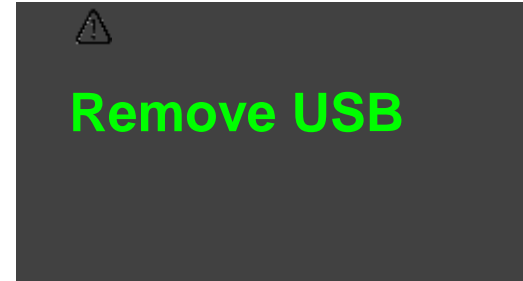

Screen messages during auto-restart

- When the display shows “Remove USB”.
Unplug the USB stick.
- The system will perform an auto-restart.
- Wait a few minutes until the system returns to standby mode.

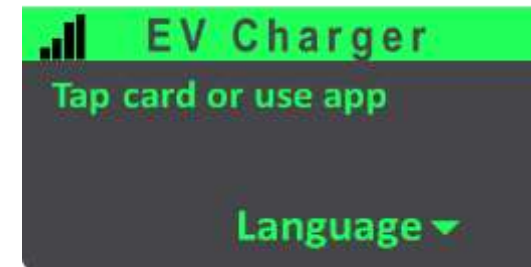
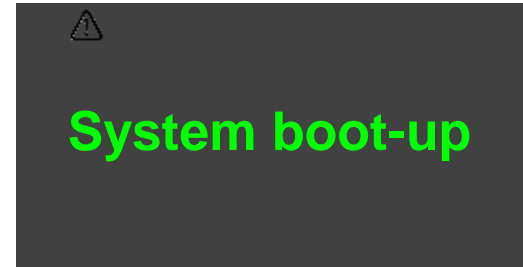
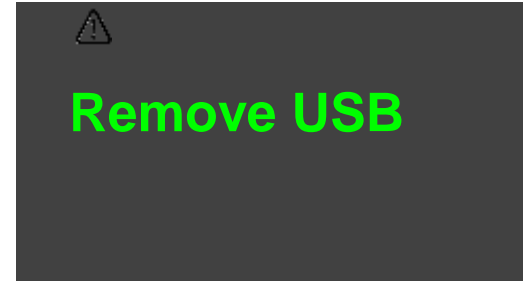

Step 5: Download the new log file

- Insert the 3rd USB stick to download the new log file.



USB port at the bottom

Step 6: Validate the result

- Unzip the new log file using the password: serialnumber@delta.
- For example, if the serial number is ZJ3183000069WE, then the password is ZJ3183000069WE@delta

[2019.08.16-08.57]ZJ3183000069WE.zip

Serialnumber
Minute
Hour
Date
Month
Year

Step 6: Validate the result

- Go to the 2nd layer of the folder.
- Open the file “DownloadConfiguration” with an application like “Notepad”.

1st layer

2nd layer

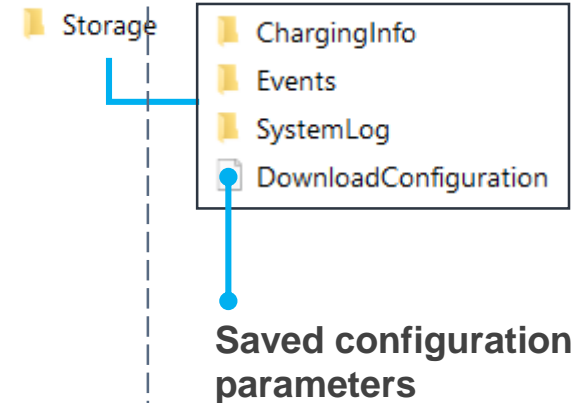

Step 6: Validate the result

Verify the firmware versions are as shown:

Single model:

CUM02BA firmware version: v02.05.12.21.11

CUM02CA firmware version: v01.0B.02.xx

Relay Board firmware version: v01.03.02.00

Aux Power firmware version: v00.04.05.00

Dual model:

CUM02BA firmware version: v02.05.12.41.11

CUM02CA firmware version: v01.0B.02.xx

Relay Board firmware version: v01.03.02.00

Aux Power firmware version: v00.04.05.00

Step 6: Validate the result

Verify the firmware versions are as shown:

Single model:

CUM02BA firmware version: v02.05.12.21.11

CUM02CA firmware version: v01.0B.02.xx

Relay Board firmware version: v01.03.02.00

Aux Power firmware version: v00.04.05.00

Dual model:

CUM02BA firmware version: v02.05.12.41.11

CUM02CA firmware version: v01.0B.02.xx

Relay Board firmware version: v01.03.02.00

Aux Power firmware version: v00.04.05.00

Step 6: Validate the result

- Verify the other configuration parameters.
- Unzip the old log file from the 1st USB stick as well, and check there is no mismatch between the two “DownloadConfiguration” files in the 1st and 3rd USB sticks.
- It is recommended to verify the parameters shown below, all the values should be identical. If not, please create a new configuration file and perform the upload again.

Authentication Mode: ---example---only
3G APN: ---example---only
3G CHAP_PAP_ID: ---example---only
3G CHAP_PAP_PASSWORD: ---example---only
Backend System: ---example---only
OCPP local list: ---example---only
OCPP offline policy: ---example---only
OCPP Charge Box ID: ---example---only
OCPP Charge Point Model: EVDE25E4DUM
OCPP Server URL: ---example---only
OCPP model: ---example---only
Max Charging Power (kW): ---example---only

Old “DownloadConfiguration” example

Cross check



Authentication Mode: ---example---only
3G APN: ---example---only
3G CHAP_PAP_ID: ---example---only
3G CHAP_PAP_PASSWORD: ---example---only
Backend System: ---example---only
OCPP local list: ---example---only
OCPP offline policy: ---example---only
OCPP Charge Box ID: ---example---only
OCPP Charge Point Model: EVDE25E4DUM
OCPP Server URL: ---example---only
OCPP model: ---example---only
Max Charging Power (kW): ---example---only

New “DownloadConfiguration” example

Smarter. Greener. Together.

Thank you!

Name:

Email:

Phone:

www.delta-emea.com

